



Property type : Detached Villa

Location : Mijas

Bedrooms : 3

Bathrooms : 2

Swimming pool : Private

Garden : Private

Orientation : South

Views : Mountain views

Parking : 1 underground parking

House area : 278 m²

Plot area : 500 m²

✓ Fitted wardrobes

✓ Utility room

✓ Not furnished

✓ Storage room

✓ Terrace

✓ Airconditioning

✓ Central heating

✓ White goods

Off pan villa on a plot located on a hill in the urbanisation of Campo Mijas.

The villa designed on 3 levels comprises:

- Basement level with private garage, installation and storage room, WC, office and access to the terraced pool area.

- Ground Floor with entrance porch the living room, kitchen-diner, and guest bathroom. Patio doors open out to a terrace overlooking the pool.

- Top Floor with 3 bedrooms, the master with en-suite & walk-in wardrobe, bedrooms 2 and 3 with fitted wardrobes and access to the upper terrace.

The garden with pool will be landscaped with decorative plants and trees.

The design of the villa will be adjusted to the client's taste with a wide range of options in design and qualities so the client can easily create his or her living spaces.





Nivel -1

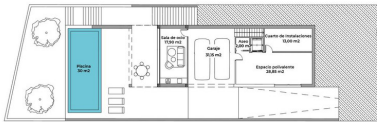

GENERALES:

Pavimento	500m ²
TOTAL CONCRETADO	238 m ²
Alacena	238 m ²
Alacena	38 m ²
Piscina	50 m ²
Terraza	180 m ²
Gravelo	180 m ²
Placas Parking Cobiertas	2 ud
Placas Parking No Cobiertas	6 ud

Los datos reflejados en este documento son orientativos, sin valor contractual

Nivel 0



GENERALES:

Pavimento	500m ²
TOTAL CONCRETADO	238 m ²
Alacena	238 m ²
Alacena	38 m ²
Piscina	50 m ²
Terraza	180 m ²
Gravelo	180 m ²
Placas Parking Cobiertas	2 ud
Placas Parking No Cobiertas	6 ud

Los datos reflejados en este documento son orientativos, sin valor contractual

Nivel +1



GENERALES:

Pavimento	500m ²
TOTAL CONCRETADO	238 m ²
Alacena	238 m ²
Alacena	38 m ²
Piscina	50 m ²
Terraza	180 m ²
Gravelo	180 m ²
Placas Parking Cobiertas	2 ud
Placas Parking No Cobiertas	6 ud

Los datos reflejados en este documento son orientativos, sin valor contractual