



**Property type :** Penthouse

**Swimming pool :** Communal

**House area :**

115 m<sup>2</sup>

**Location :** Santa Pola

**Bedrooms :** 2

**Bathrooms :** 2

- ✓ Gymnasium
- ✓ Pre-air conditioning

- ✓ Lift

- ✓ Solarium

#### NEW BUILD RESIDENTIAL COMPLEX IN SANTA POLA

New Build modern gated residential complex consisting of 1, 2 and 3 bedroom apartments and penthouses with 2 complete bathrooms. The complex consists of 4 staircases of flats with spacious landscaped communal areas, including swimming pool, relaxation area and gymnasium.

All properties have been carefully designed to provide you with an exceptional living experience, with high quality finishes and a modern style. Enjoy the spacious terraces, where you can relax, enjoy al fresco dining and watch the most spectacular sunsets.

The location is simply unbeatable: next to the centre of Santa Pola and the palm grove, and only a few minutes from the promenade, you will be close to a wide range of restaurants, bars and supermarkets.

Excellent connection with the national road 332, which connects all the southern Costa Blanca, and with the airport in only 15 minutes.





PLANTA ATICO/ ESCALERA 2  
VIVIENDA 4



SUPERFICIE UTILES		SUPERFICIE CONSTRUIDAS	
Desploma	7,83	Cocina	13,11
Baño-comedor-cocina	25,30	Alameda	83,43
Escaleras 1	13,24		
Baño 1	3,84		
Escaleras 2	7,41		
Baño 2	8,35		
Comedor	22,23		
<b>TOTAL</b>	<b>108,54</b>		<b>108,54</b>

Las superficies indicadas se dan con carácter orientativo, si constituirían y pueden sufrir algunas variaciones por modificaciones técnicas del proyecto de construcción.

PLANTA SOLARIUM/ ESCALERA 2  
VIVIENDA 4

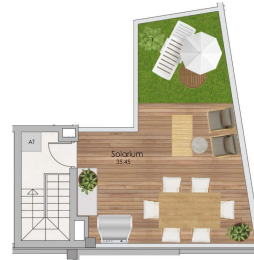

SUPERFICIE UTILES		SUPERFICIE CONSTRUIDAS	
Desploma	2,86	Cocina	10,02
Escaleras-comedor	18,50	Baño	8,43
Escaleras 1	0,91		
Baño 1	3,17		
Escaleras 2	1,8		
Baño 2	3,95		
Comedor	18,15		
Solarium	23,45		
<b>TOTAL</b>	<b>83,82</b>		<b>108,45</b>

Las superficies indicadas se dan con carácter orientativo, si constituirían y pueden sufrir algunas variaciones por modificaciones técnicas del proyecto de construcción.

